

# GROUND FLOOR

## CONFERENCE, TRAINING & MEETING ROOMS

- 13 air-conditioned meeting rooms, all with natural daylight
- 117 executive double or twin bedrooms with separate work and relaxation area
- Creative Spaces - a new way of working to produce the best results
- Conference Café - a unique concept for all-day refreshments including light and healthy options for lunch.
- First Class spa with 13m pool, Technogym, fibre optic steam room, colour therapy sauna, jacuzzi, dance studio and tennis court.
- Terrace restaurant or private rooms for evening dining - plus al fresco options in the summer months
- Manned Business Centre as one single point of contact for your event
- Delegate rates that include
  - inspiring lunch options
  - all snacks and unlimited servings of
  - tea, coffee and juices
  - complimentary hi-speed wireless access
  - free car parking

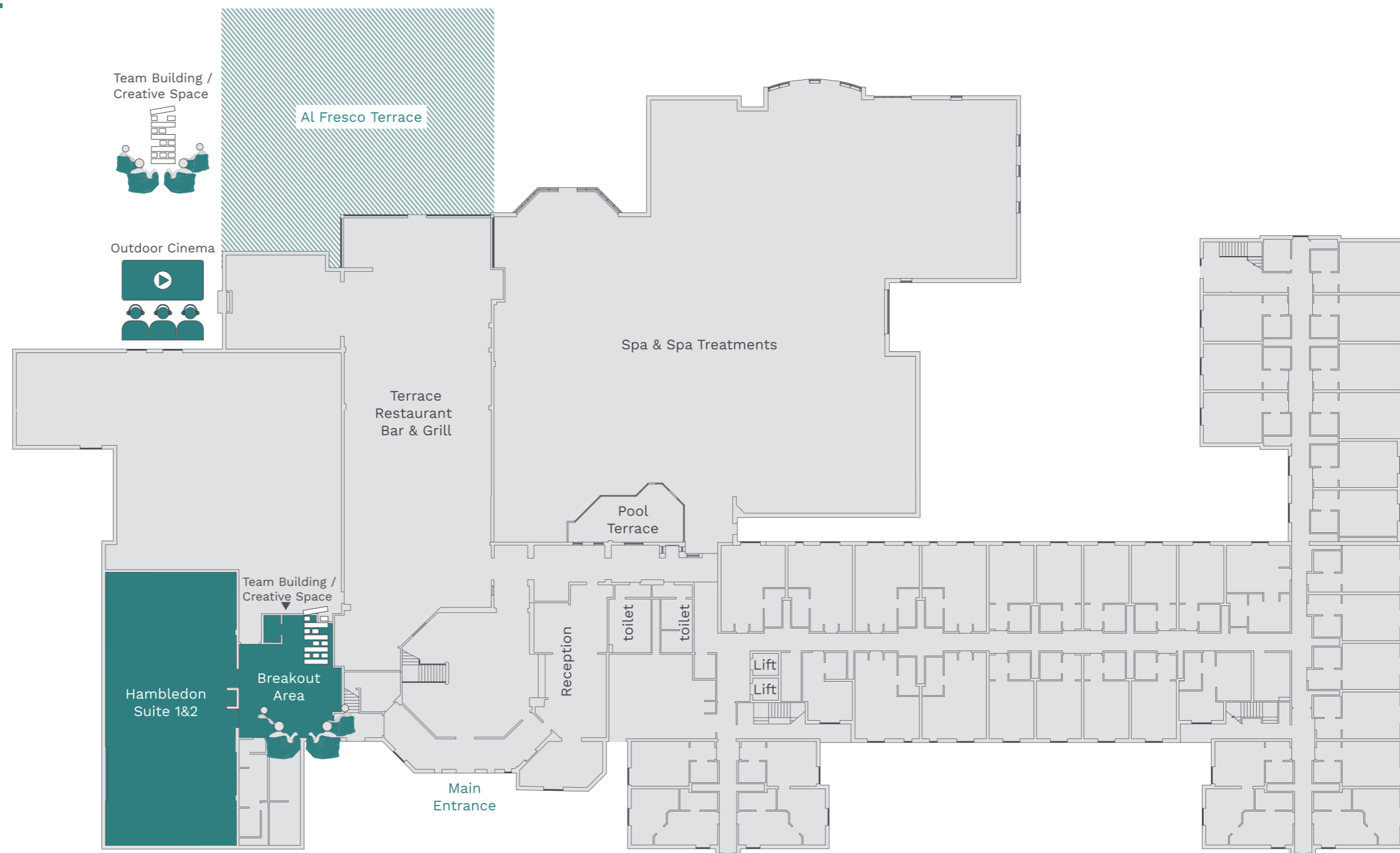

# FIRST FLOOR

## Maximum Capacity with Equipment

CAPACITY DIMENSIONS	HAMBLEDON SUITE (G) 21.8M X 10.6M	HAMBLEDON I (G) 10.9 X 10.6	HAMBLEDON II (G) 10.9M X 10.6M	CARISBROOKE SUITE (1) 15.4M X 10.1M	CARISBROOKE ROOM (1) 10.1M X 7.4M	BEMBRIDGE ROOM (1) 8M X 4.7M	OSBORNE ROOM (1) 8M X 4M	BEMBRIDGE & OSBORNE ROOM (1) 16M X 4.7M	DORCHESTER SUITE (1) 18.5M X 8.2M	ARUNDEL ROOM (1) 9.2M X 8.2M	DORCHESTER ROOM (1) 9.2M X 8.2M	ELING/ASHLETT/BEAULIEU/FAREHAM LANGSTONE/EMSWORTH (1) 6.4M X 5.9M
THEATRE	240	110	110	120	70	18	18	60	76	40	40	-
CLASSROOM	100	50	50	72	35	-	-	36	60	30	30	-
BOARDROOM	60	40	40	30	30	16	16	24	50	25	25	10
U-SHAPE	-	30	30	50	25	14	14	24	50	25	25	-
BANQUET	180	60	60	100	60	-	-	-	90	-	-	-
DINNER DANCE	160	-	-	100	60	-	-	-	70	-	-	-
CABARET	100	50	50	72	35	-	-	36	76	36	36	-

Please note: Arundel and Dorchester rooms can be combined to make the Dorchester Suite.  
The Carisbrooke, Bembridge and Osborne rooms can be combined to make the Carisbrooke Suite.

